

**SCHEME EXTENTS
CLEARWAY AMENDMENTS**

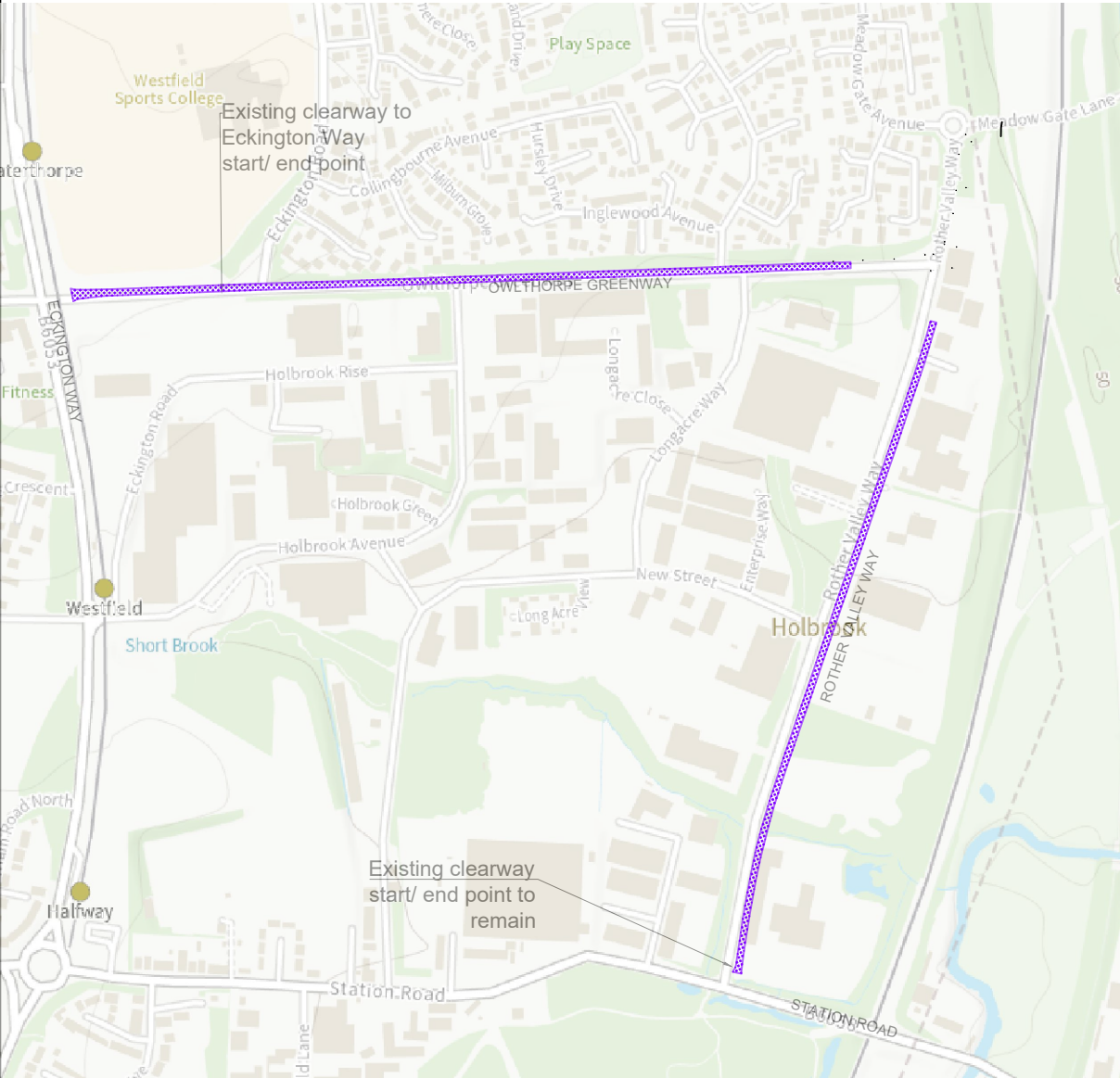

NOTES:

- Amending clearways on Rother Valley Way and Owthorpe Greenway and in the proposed waiting restrictions (yellow lines) to leave gaps in suitable places for on street parking.
- Removing the roundabout junction from the network and changing this area to provide additional parking close to the park entrance.
- A shared use footway on Owthorpe Greenway linking to Rother Valley Way
- Provide a refuge on Rother Valley Way to assist pedestrian and cycle movements
- Extensive waiting restrictions on main routes and some within residential estates at locations where parking should be prevented.
- A traffic calming feature (flat top plateau) on Rother Valley Way to assist with speed management and provide additional crossing opportunities.
- Relocation or removal of the bus stop. Only one service per weekday currently. The existing bus stand is used for parking and this could be made permanent.

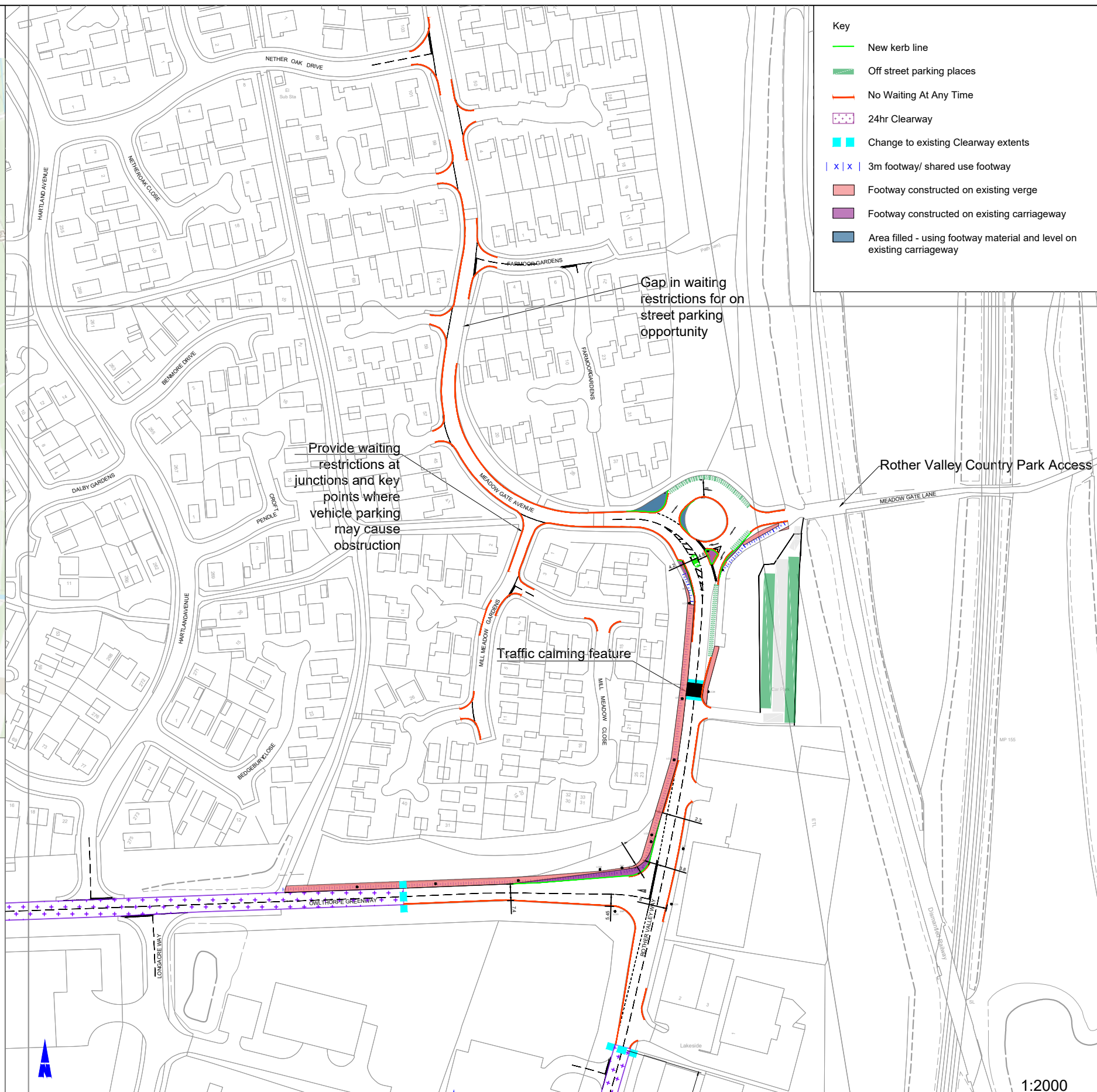

Key

- New kerb line
- Off street parking places
- No Waiting At Any Time
- 24hr Clearway
- Change to existing Clearway extents
- 3m footway/ shared use footway
- Footway constructed on existing verge
- Footway constructed on existing carriageway
- Area filled - using footway material and level on existing carriageway

TRANSPORT PROJECTS SERVICE
 STRATEGIC TRANSPORT,
 SUSTAINABILITY & INFRASTRUCTURE
 5th FLOOR, HOWDEN HOUSE
 1, UNION STREET, SHEFFIELD, S1 2SH
 E-mail Scheme.Design@Sheffield.gov.uk
Tom Finnegan-Smith - Head of Service

Client **SHEFFIELD CITY COUNCIL**
 Scheme **Rother Valley Way Scheme**
 Drawing Title **Scheme Proposal - Traffic Regulation Orders**

Drawing No. **2148-GA-RV003C**
 DRAWN BY **RB** **Feb 2023**
 CHECKED
 Scale **As shown**
 Date **Feb 2023**
A3